

# Announcing the New International Dormitory: BKC International House!

Architect's rendering



For Ritsumeikan University Students!

Just 5 Minutes Walk from Campus!

6-1-1 Matsugaoka, Otsu, Shiga

24 - Hour, English - Speaking Staff!

Free Internet in All Rooms!

## Facilities Description

In each Private Room	Bed, Desk & Chair, Refrigerator, Air Conditioner, lighting, Internet, Sink, Toilet w/ Washlet *Type-B rooms also include showers.
Common Use Facilities	Kitchen Lounge (with TV & DVD Player) 1st-4th Floor: Shower Room, Laundry Room (with dryer) Multipurpose Hall with Tatami Corner (with TV & DVD Player) Recreation Facilities (Table Tennis, Billiard Table, Basketball hoop, etc)

Student Rooms	Area	Rate (water included)	To rent bedding:	Total	Electricity
Type A	apr. 13m <sup>2</sup>	39,000 yen/month	2,000 yen/month	41,000 yen	As used
Type B		47,000 yen/month	2,000 yen/month	49,000 yen	As used
4-man Room	apr. 16.5m <sup>2</sup>	600 yen/person/day	500 yen/stay	1,100 yen+	
8-man Room	apr. 25m <sup>2</sup>	600 yen/person/day	500 yen/stay	1,100 yen+	

Rates listed above are current as of Sept 2012 and are subject to change.

A deposit equal to one month's rent is required upon entrance for room types A & B.

Kitchen Model



Architect's rendering

Common use hall and Tatami corner



Architect's rendering

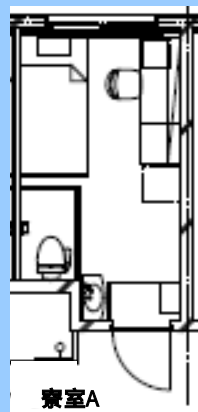

寮室A

Type A Model  
Architect's Rendering



■ 寮室A

\*Toilet in each room!



寮室B

Type B Model  
Architect's Rendering



寮室B

\*Toilet/shower in each room!

\*Actual rooms may vary from architect's renderings